

**NOTES:**  
 All dimensions in metres.  
 Do not scale from drawing.  
 For any discrepancies found please consult with design office.  
 This drawing is for PLANNING purposes only.  
 Not for Construction.

**Legend:**  
 Note: Drawing To Be Read in Conjunction With Irish Water: Water Infrastructure Standard Details Document Number: IW-CDS-5030-01 & Irish Water Code of Practice for Wastewater Infrastructure: IW-CDS-5030-03

Standard separation distances refer to STD-WW-05 & STD-WW-06  
 All gravity foul sewers to be uPVC.  
 All rising mains to be Polyethylene (P.E)

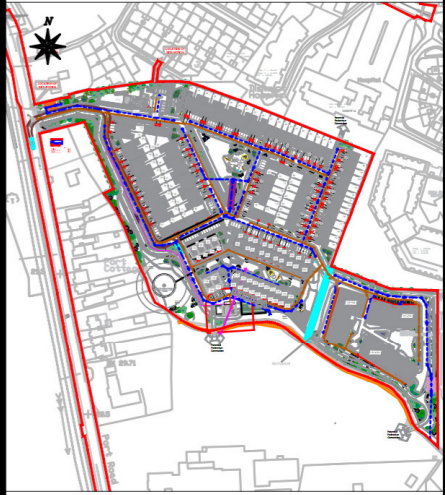
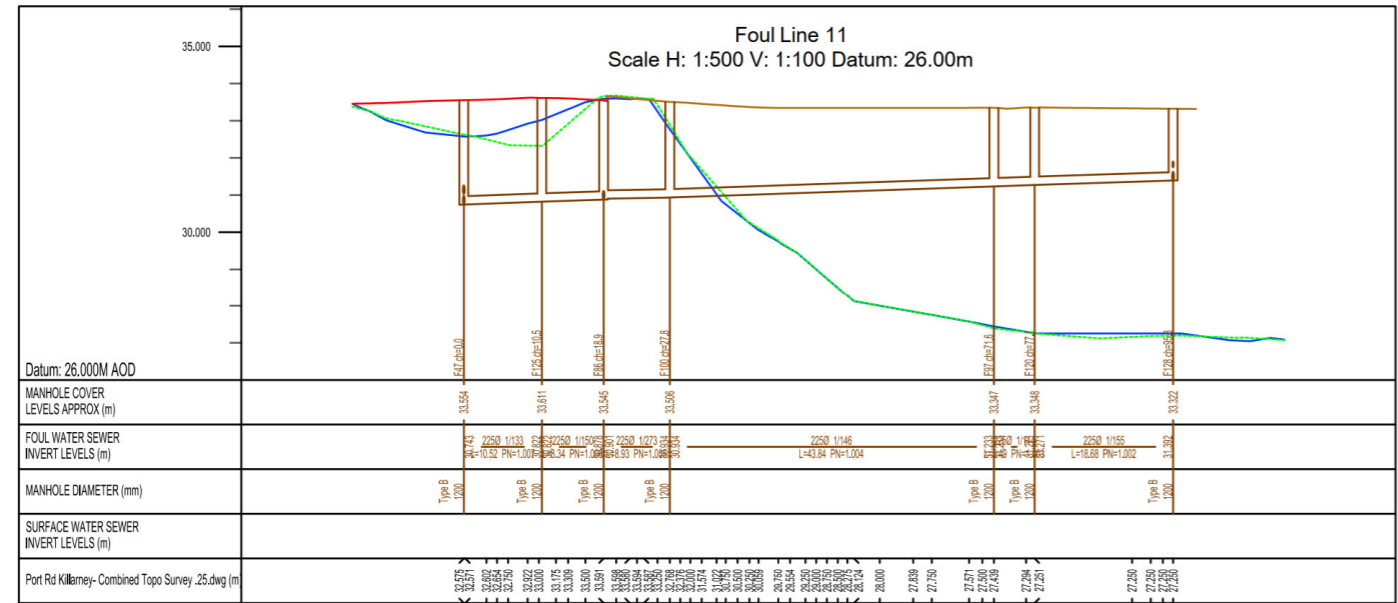
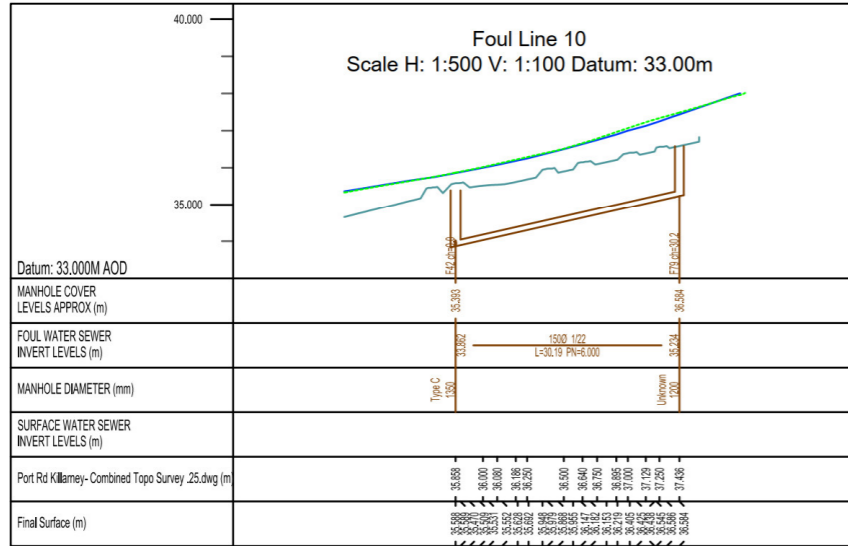

Rev	By	Date	Description
<b>G</b>	<b>DM</b>	<b>04/24</b>	<b>IW Revision</b>

Drawing Status: **PLANNING**

**Project Title:**  
 Residential Development at Inch / Coolgrean,  
 Port Road, Killarney

**Drawing Title:**  
 Proposed Wastewater Lines Longsections  
 Sheet 7

**Client:**  
 Portal Asset Holdings Ltd.

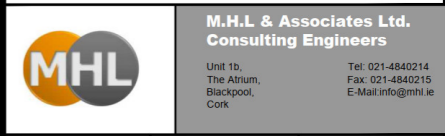

<b>Designed:</b> DM	<b>Drawn:</b> DM	<b>Checked:</b> BM
<b>Scale:</b> 1:500 @A1 1:1000 @A3	<b>Date:</b> APRIL 2024	
<b>Job No:</b> 18137HD	<b>Drawing No:</b> PR-MHL-PS-P07	<b>Revision:</b> _G

